

- Locking system with snap hooks
- 12 contacts
- Degree of protection IP54
- Solder termination
- Ergonomic design of connector
- Colour in greywhite similar to RAL 9002



Description

Male cable connector

Drawing

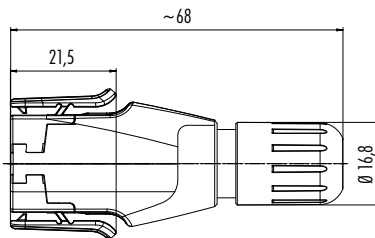

Contacts	Cable outlet max.	Ordering-No.
12	4–6 mm	99 1721 002 12
	6–8 mm	99 1721 000 12

Female panel mount connector, solder

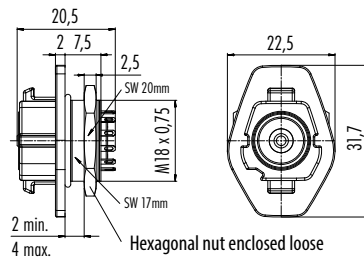

Contacts	Ordering-No.
12	99 1724 000 12

Female panel mount connector, solder

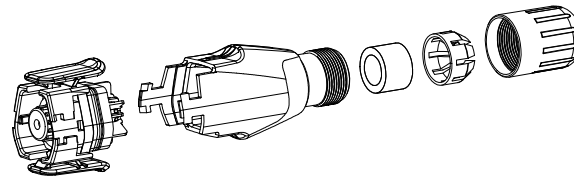

- Male contact body
- Male insert
- Sealing
- O-ring
- Male contact solder
- Sleeve
- Seal
- Pinch ring
- Pressing screw

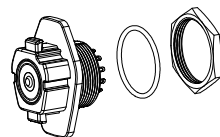

- Female contact body
- Female insert
- Contact spring solder
- O-ring
- Hexagonal nut

Specifications

Contacts	12
Wire gauge	max. 0,25 mm ² (max. AWG 24)
Mechanical operation	> 5000 Mating cycles
Temperature range	-25 °C / + 85 °C
Rated voltage	175 V
Pollution degree	2
Rated current (40°C)	2 A
Contact plating	Au (Gold)
Material of housing	PA 66

Contact arrangements male insert (termination side)

12 contacts

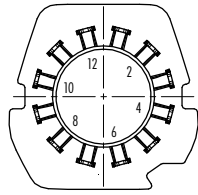

	X	Y
1	1,59	5,94
2	4,35	4,35
3	5,94	1,59
4	5,94	-1,59
5	4,35	-4,35
6	1,59	-5,94
7	-1,59	-5,94
8	-4,35	-4,35
9	-5,94	-1,59
10	-5,94	1,59
11	-4,35	4,35
12	-1,59	5,94

Contact arrangements female insert (termination side)

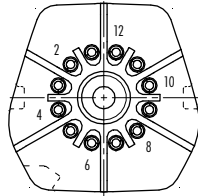

	X	Y
1	-1,09	4,06
2	-2,97	2,97
3	-4,06	1,09
4	-4,06	-1,09
5	-2,97	-2,97
6	-1,09	-4,06
7	1,09	-4,06
8	2,97	-2,97
9	4,06	-1,09
10	4,06	1,09
11	2,97	2,97
12	1,09	4,06

Panel cut out

Panel mount connectors

Alternative with flats

Mounting wall

